

Achtung: Montage mit erhöhter Genauigkeit gefordert. Abweichung in x, y und z-Richtung max. ±10 mm.

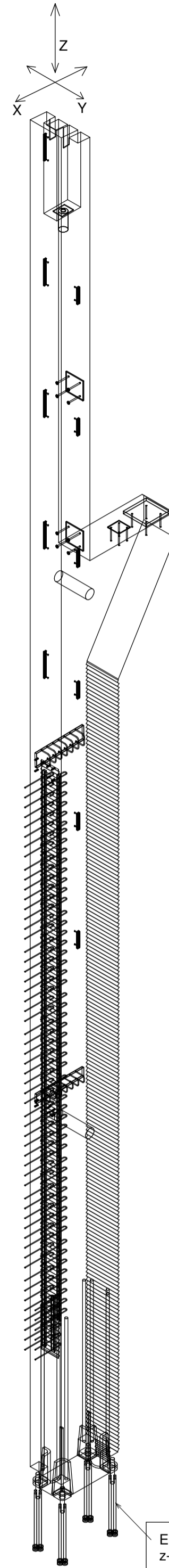

3D

Einbau - Abweichung in x, y und z-Richtung max. ±10mm.

DETAIL KRANLAGER

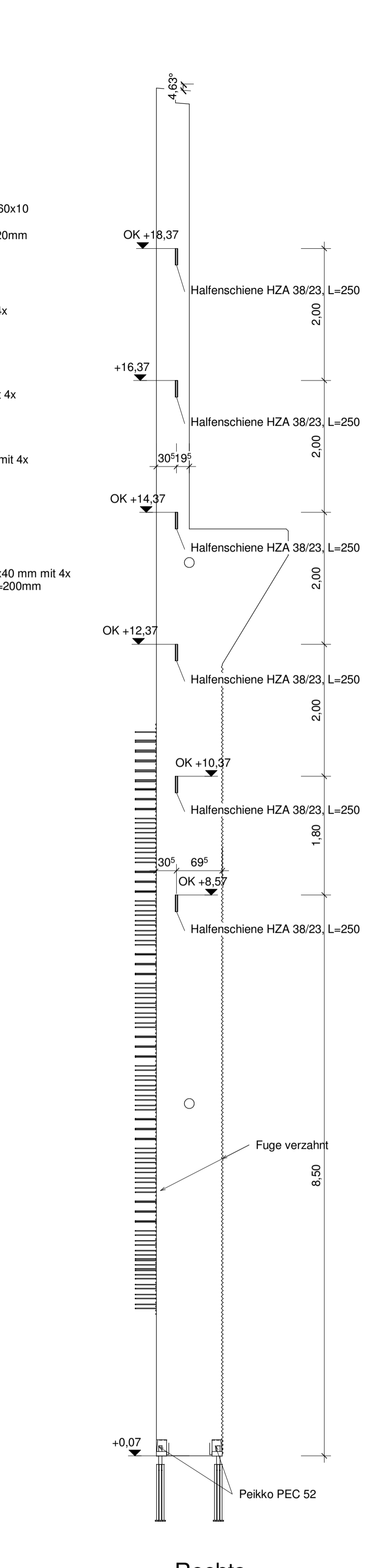
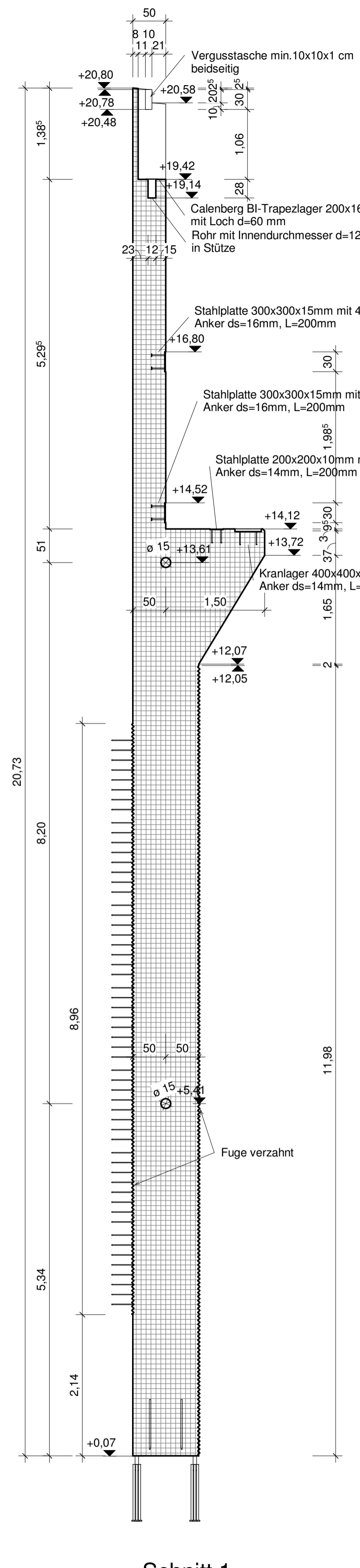
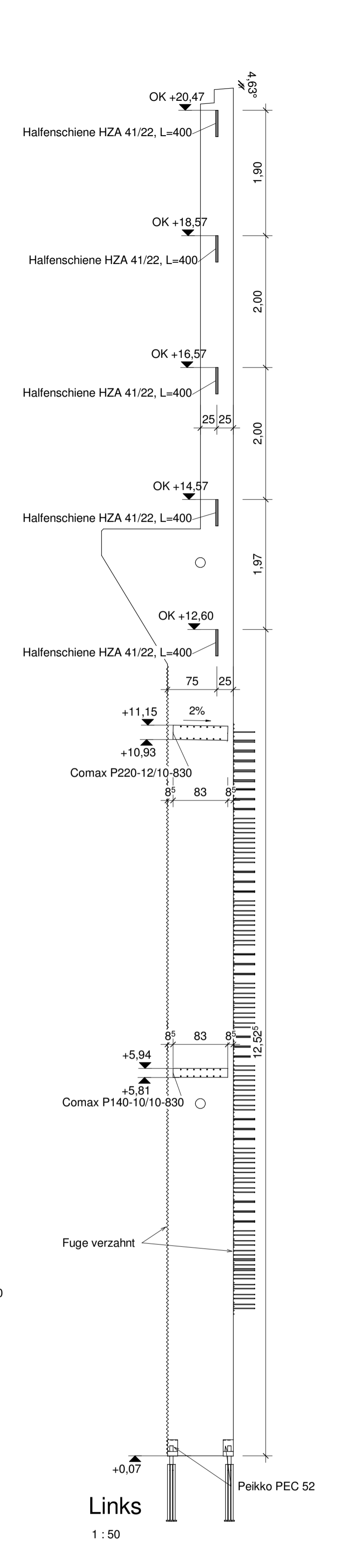
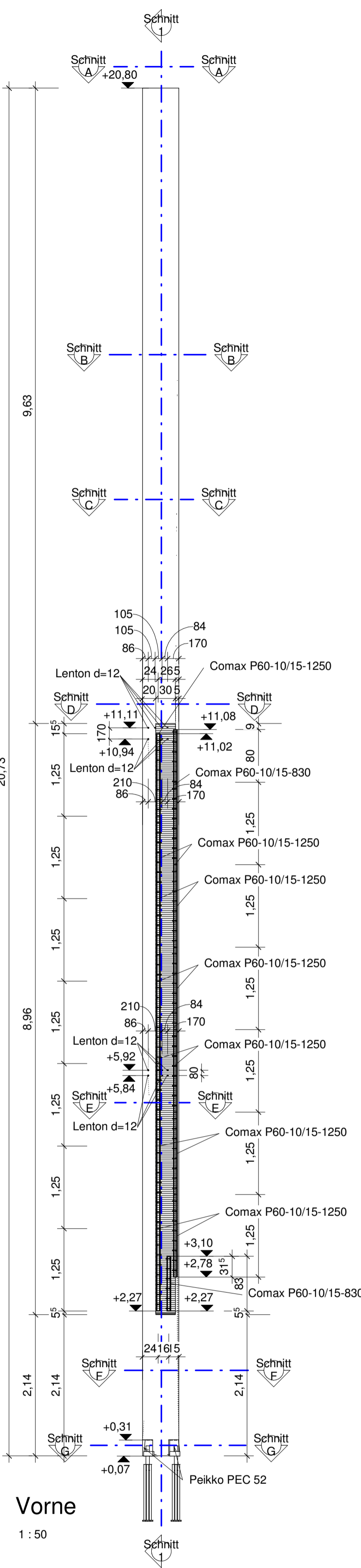
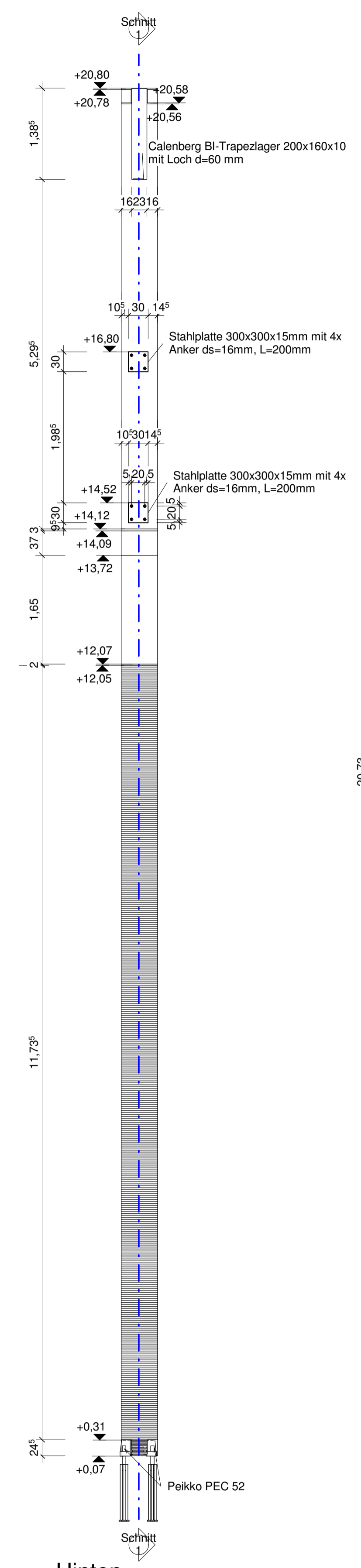
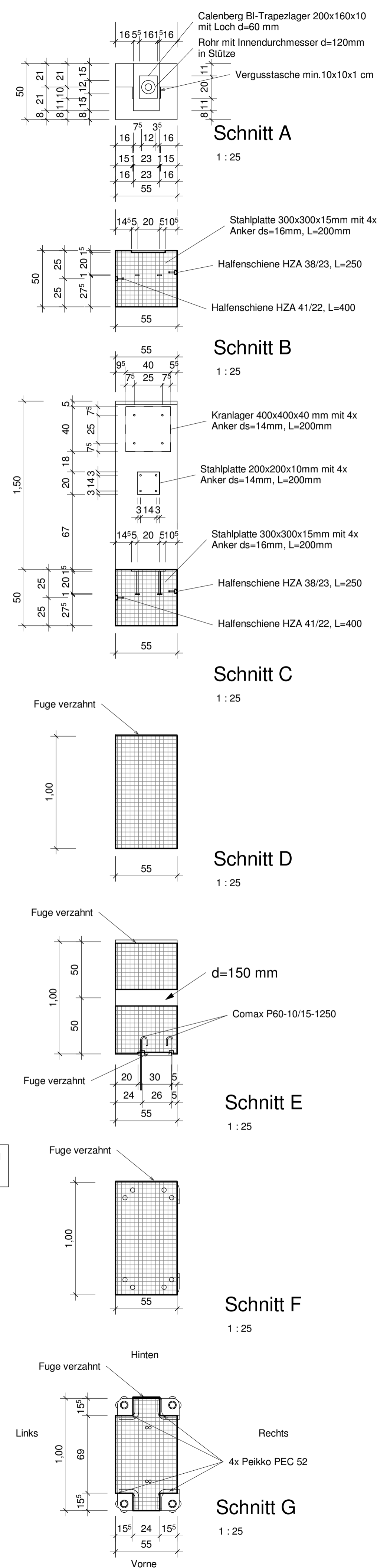
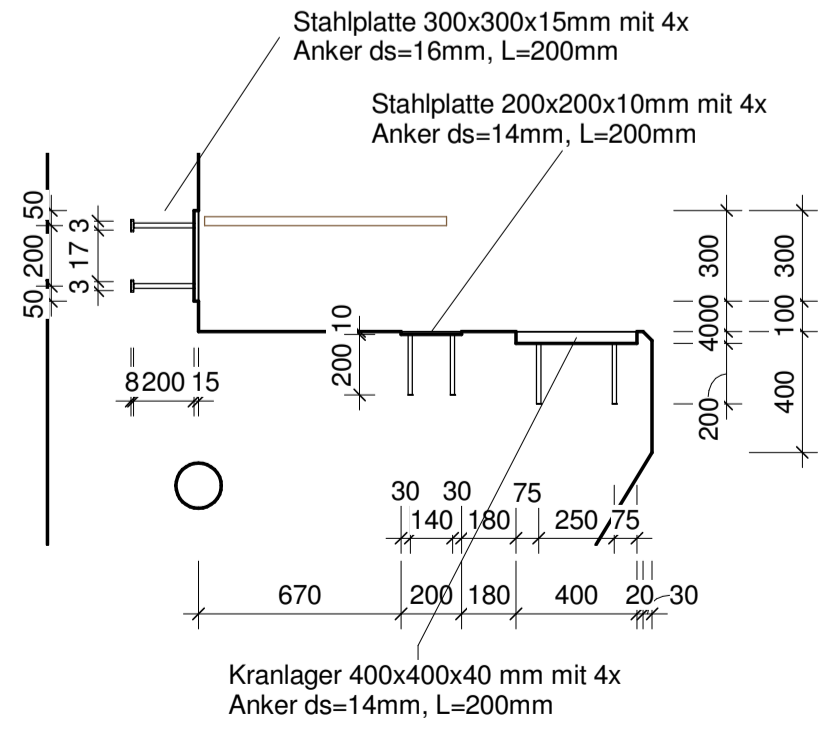

Liste Einbauteile	
Abmessungen	Anzahl
4x Peikko PEC 52-2695	1
Calenberg BI-Trapezträger 200x160x10mm mit Loch d=60mm	1
Comax P 60-10/15-830	2
Comax P 60-10/15-1250	13
Comax P 140-10/10-830	1
Comax P 220-12/10-830	1
Halfenschiene HZA 38/23, L=250, FV	6
Halfenschiene HZA 41/22, L=400, FV	5
Kranlager 400x400x40mm mit 4x Anker ds=14mm, L=200mm	1
Lenton-Standardmuffe A12, d=12	13
Montagerohr Ø 120, l=280	1
Stahlplatte 200x200x10mm mit 4x Anker ds=14mm, L=200mm	1
Stahlplatte 300x300x15mm mit 4x Anker ds=16mm, L=200mm	2

Liste Fertigteilstütze		
Position	Anzahl	Material
POS 3.05_S5	1	Fertigbeton C45/55